

	A	B	C	D
1	ANTHONY SANNEH	8400 22ND AVE S	BLOOMINGTON MN 55425-1815	342923240104
2	ANTHONY SANNEH	8400 22ND AVE S	BLOOMINGTON MN 55425-1815	342923240103
3	KREBSBACH PROPERTIES	5353 WAYZATA BLVD STE 650	MINNEAPOLIS MN 55416-1349	342923240236
4	BLACK HART PROPERTIES LLC	1251 CHARLES AVE	SAINT PAUL MN 55104-2517	342923240225
5	ASAD AL-GHALITH	1424 SHERBURNE AVE	SAINT PAUL MN 55104-2413	342923240205
6	LINDA MARIE KNIGHT	1424 SHERBURNE AVE	SAINT PAUL MN 55103-2413	342923240206
7	LUANN K SCHOWALTER	1418 SHERBURNE AVE	ST PAUL MN 55104-2413	342923240204
8	BECKY ANN JOHNSON	1402 SHERBURNE AVE	SAINT PAUL MN 55104-2413	342923240200
9	RYAN SENENSKY	1414 SHERBURNE AVE	SAINT PAUL MN 55104-2413	342923240203
10	MARA SOLIS	1410 SHERBURNE AVE	SAINT PAUL MN 55104-2413	342923240202
11	GHOLAMREZA ASHRAFZADEHKIAN	3817 BEARD AVE S	MINNEAPOLIS MN 55410-1040	342923240201
12	MAHER SAFI	1 MAYCOMB LN	SAINT PAUL MN 55127-4500	342923240226
13	HOUSING AND REDEV AUTH ST PAUL	25 4TH ST W STE 1100	ST PAUL MN 55102-1634	342923240233

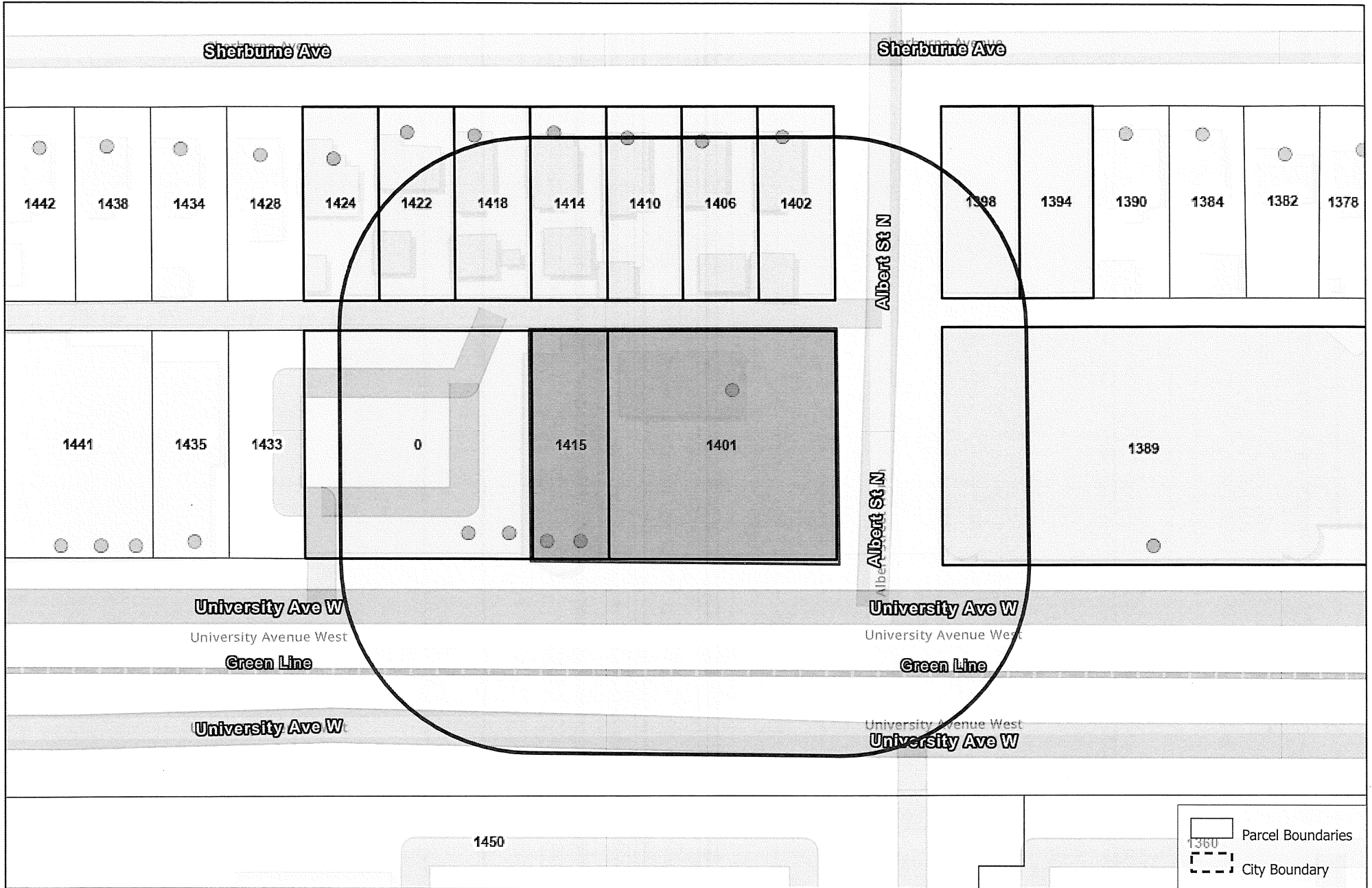

Sources: Esri, Airbus DS, USGS, NGA, NASA, CGIAR, N Robinson, NCEAS, NLS, OS, NMA, Geodatastyrelsen, Rijkswaterstaat, GSA, Geoland, FEMA, Intermap and the GIS user community, Esri Community Maps

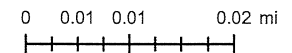

The Geographic Information System (GIS) Data to which this notice is attached are made available pursuant to the Minnesota Government Data Practices Act (Minnesota Statutes Chapter 13). The GIS Data are provided to you "AS IS" and without any warranty as to their performance, merchantability, or fitness for any particular purpose. The GIS Data were developed by the City of Saint Paul for its own internal business purposes. The City of Saint Paul does not represent or warrant that the GIS Data or the data documentation are error-free, complete, current, or accurate. You are responsible for any consequences resulting from your use of the GIS Data or your reliance on the GIS Data. You should consult the data documentation for this particular GIS Data to determine the limitations of the GIS Data and the precision with which the GIS Data may depict distance, direction, location, or other geographic features. If you transmit or provide the GIS Data (or any portion of it) to another user, the GIS Data must include a copy of this disclaimer.