



CITY OF SAINT PAUL
OFFICE OF THE CITY COUNCIL

310 CITY HALL
15 WEST KELLOGG BOULEVARD
SAINT PAUL, MN 55102-1613
Marcia Moermond, Legislative Hearing Officer
EMAIL: legislativehearings@ci.stpaul.mn.us
PHONE: (651) 266-8585 FAX: (651) 266-8574

June 10, 2022

Lucas & Rebecca Pelton

VIA EMAIL: becca.pelton@gmail.com

Re: Appeal for Property at 1696 Juliet Avenue

This is to confirm that at the Legislative Hearing on June 7, 2022, Legislative Hearing Officer Marcia Moermond will **recommend your appeal is granted conditioned upon removing the planter barrels and raised garden bed from public right of way, providing information on mosquito prevention design of rain barrel, and submission of a work plan and diagram of the property being reviewed and approved by staff.**

Those documents can be emailed to legislativehearings@ci.stpaul.mn.us and will be sent to staff to review. They will be discussed at a Legislative Hearing on June 14, 2022 between 11:00 a.m. and 1:00 p.m. Should you wish to participate in this hearing please let me know.

This matter will be scheduled to go before the City Council on Wednesday, July 13, 2022 at 3:30 pm, in room 300 City Hall. If you are contesting Ms. Moermond's recommendation, you may appear in person or send written testimony to be added to the record to legislativehearings@ci.stpaul.mn.us or by voicemail at 651-266-6805. Should you wish to address Council directly but not appear in person, you must register in person by noon on the Tuesday immediately prior to your Public Hearing here: <https://www.stpaul.gov/department/city-council/city-council-public-hearing-live-testimony>. If you don't wish to contest, no further action is needed and the Council will proceed with Ms. Moermond's recommendation above.

If you have any questions, please contact me at 651-266-8585.

Sincerely,

/s/

Joanna Zimny
Legislative Hearing Executive Assistant



Conditions

- removing the planter barrels - **view (iv) page 3**
- and raised garden bed - **view (i) page 3-** from public right of way
- providing information on mosquito prevention design of rain barrel - **page 4**
- submission of a work plan and diagram of the property - **pages 5-6**

Public Right of Way

- i removing the raised garden bed from public right of way



- iii removing the planter barrels from public right of way



Mosquito Control

500 Gallon Tank (A), 200 Gallon Tank (B)

Airtight water inlet (A,B)

Airtight cleaning access (A,B)

Any unused holes are sealed (B)



(A)

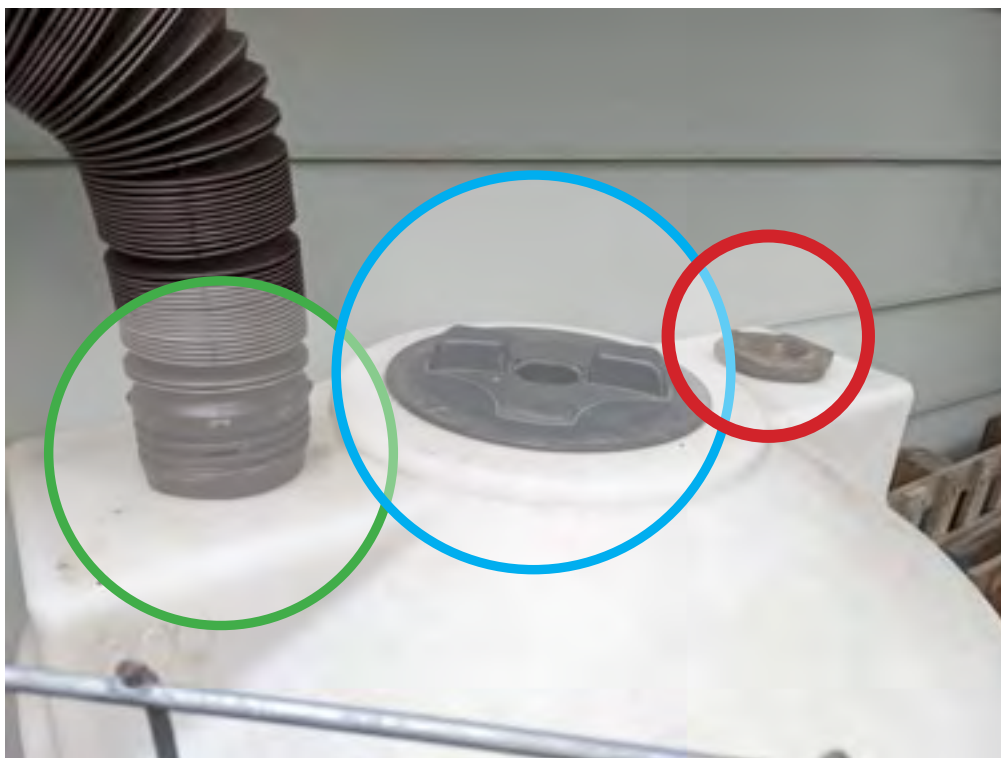

(B)

Property Diagram

A, D, E, F - Full Sun Vegetable Garden

B - Part Sun Garden + Decoratives

Raspberry (in-ground)

Any of the following:

- Poke Milkweed (*Asclepias exaltata*)
- Maidenhair Fern (*Adiantum pedatum*)
- Early Meadowrue (*Thalictrum dioicum*)
- Wild Geranium (*Geranium maculatum*)
- Wild Ginger (*Asarum canadense*)
- Jack-in-the-pulpit (*Arisaema triphyllum*)
- Wild Violet (*Viola* spp.)
- Red Baneberry (*Actaea rubra*)
- Zigzag Goldenrod (*Solidago flexicaulis*)
- Bloodroot (*Sanguinaria canadensis*)
- Virginia Waterleaf (*Hydrophyllum virginianum*)
- Pennsylvania Sedge (*Carex pennsylvanica*)
- Rosy Sedge (*Carex rosea*)
- Bottlebrush Grass (*Elymus hystrix*)

C - Full Sun Decoratives

Any of the following:

- Heartleaf Golden Alexander (*Zizia aptera*)
- Stiff Goldenrod (*Solidago rigida*)
- Bee Balm (*Monarda fistulosa*)
- Butterfly Milkweed (*Asclepias tuberosa*)
- Common Yarrow (*Achillea millefolium*)
- Purple Prairie Clover (*Dalea purpurea*)
- Wild Onion (*Allium stellatum*)
- Thimbleweed (*Anemone cylindrica*)
- Daisy Fleabane (*Erigeron strigosus*)
- Blanketflower (*Gaillardia aristata*)
- Skyblue aster (*Aster laevis*)
- Silky Aster (*Aster sericeus*)
- Ox-Eye Sunflower (*Heliopsis helianthoides*)
- Common Milkweed (*Asclepias syriaca*)
- Narrow Leaf Coneflower (*Echinacea pallida*)
- Alumroot (*Heuchera richardsonii*)
- Wild Strawberry (*Fragaria virginiana*)
- Rattlesnake Master (*Eryngium yuccifolium*)
- Leadplant (*Amorpha canescens*)
- New Jersey Tea (*Ceanothus americanus*)
- Little Bluestem (*Schizachyrium scoparium*)
- Prairie Dropseed (*Sporobolus heterolepis*)
- Side Oats Grama (*Bouteloua curtipendula*)

G - Shaded Woodland

1. Larch
2. Red Pine
3. Hardy Kiwi Vine
4. Foxglove
5. Bladderwort

H - Mixed Part Sun Decorative Garden

6. Raspberries and Squash (new)
7. Dogwood (new)
8. Garlic, blueberries, strawberries (ext)
9. Saskatoon (new)
- 10, 11. Any of: Hosta, hydrangia, rhubarb, mint, peone, iris, lilly, bleeding heart (ext)

J - Low ground cover: Clover, fescue, etc.

K - UNALTERED AREAS

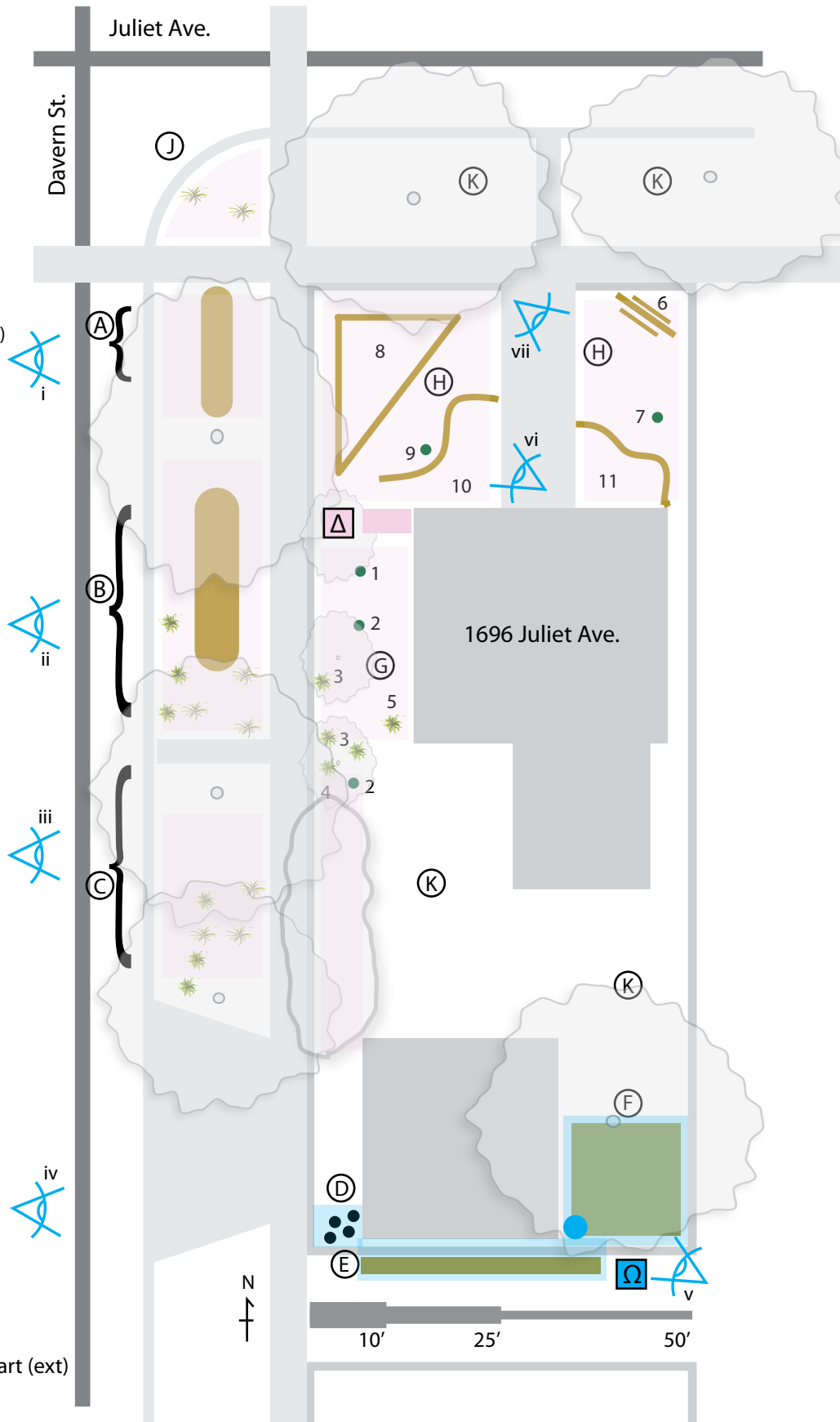

Views (i) - (vii) attached

Watering zone Δ
500 Gallon Free Standing Tank

Watering zone Ω
200 Gallon Free Standing Tank



Views (i) - (vii)

(i, ii, iii) No parkway vegetation to exceed heights indicated by STP code