

	A	B	C	D
1	PASTER FORD CLEVELAND LLC	5320 W 23RD ST STE 205	SAINT LOUIS PARK MN 55416-1667	162823220012
2	HIGHLAND GRANDVIEW LMTD PRTRNS	900 E 80TH ST	BLOOMINGTON MN 55420-1322	162823220080
3	COLLEEN A ZURO WHITE	2095 PINEHURST AVE	SAINT PAUL MN 55116-1316	172823110020
4	MARGARET C GALVIN	2103 PINEHURST AVE	ST PAUL MN 55116-1316	172823110018
5	JEFFREY A COMPTON	2079 PINEHURST AVE	SAINT PAUL MN 55116-1316	172823110024
6	MARK J POCERNICH TIA L ANDERSON	2091 PINEHURST AVE	ST PAUL MN 55116-1316	172823110021
7	JUDITH A GIULIANI	2087 PINEHURST AVE	ST PAUL MN 55116-1316	172823110022
8	SARAH L MCCULLOUGH ERIC J LESCHISIN	2099 PINEHURST AVE	SAINT PAUL MN 55116-1156	172823110019
9	PASTER FORD CLEVELAND LLC	5320 W 23RD ST STE 205	SAINT LOUIS PARK MN 55416-1667	162823220081
10	PASTER FORD CLEVELAND LLC	5320 W 23RD ST STE 205	SAINT LOUIS PARK MN 55416-1667	162823220079
11	RON P VON SUSAN OCONNOR VON	2094 PINEHURST AVE	ST PAUL MN 55116-1315	172823110076
12	PEDRO VERDEJA THERESA VERDEJA	2102 PINEHURST AVE	SAINT PAUL MN 55116-1315	172823110078
13	KATHLEEN HOLTZ MICHAEL HOLTZ	2083 PINEHURST AVE	SAINT PAUL MN 55116-1316	172823110023
14	JACKSON C WINGER ANNA CHRISTENSON	2098 PINEHURST AVE	SAINT PAUL MN 55116-1315	172823110077
15	CLEVELAND FINN LLC	1040 BAYSIDE LN	MOUND MN 55364-8963	172823110110
16	BERNICE LLC	2065 FORD PKWY	SAINT PAUL MN 55116-1814	172823110100
17	TRUSTONE FINANCIAL FEDERAL CREDIT UNION	14601 27TH AVE N STE 104	PLYMOUTH MN 55447-4834	172823110105
18	B JAFFE ST PAUL LLC	90 CHURCH ST # 7172	NEW YORK NY 10008-9772	172823110107
19	SCHULER FAMILY LLC	11400 ELM CREEK BLVD	MAPLE GROVE MN 55369-7528	172823110108

Map

2/15/2023 4:05 PM

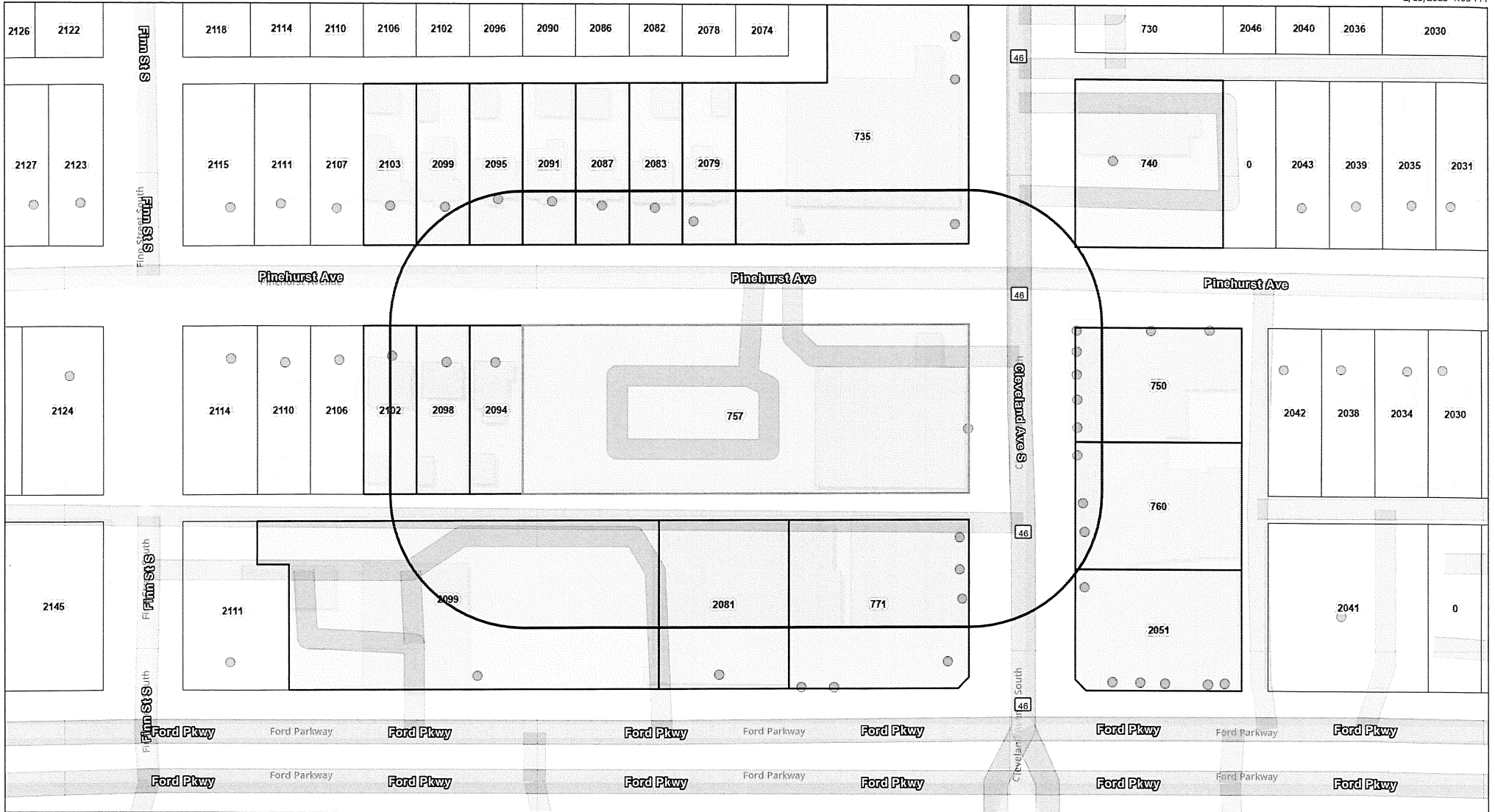

**Saint Paul Minnesota**  
*The most livable city in America*

Sources: Esri, Airbus DS, USGS, NGA, NASA, CGIAR, N Robinson, NCEAS, HLS, OS, NMA, Geotastystreisen, Rijkswaterstaat, GSA, Geoland, FEMA, Intermap and the GIS user community, Esri Community Maps

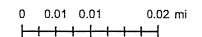

The Geographic Information System (GIS) Data to which this notice is attached are made available pursuant to the Minnesota Government Data Practices Act (Minnesota Statutes Chapter 13). The GIS Data are provided to you "AS IS" and without any warranty as to their performance, merchantability, or fitness for any particular purpose. The GIS Data were developed by the City of Saint Paul for its own internal business purposes. The City of Saint Paul does not represent or warrant that the GIS Data or the data documentation are error-free, complete, current, or accurate. You are responsible for any consequences resulting from your use of the GIS Data or your reliance on the GIS Data. You should consult the data documentation for this particular GIS Data to determine the limitations of the GIS Data and the precision with which the GIS Data may depict distance, direction, location, or other geographic features. If you transmit or provide the GIS Data (or any portion of it) to another user, the GIS Data must include a copy of this disclaimer.